

# MS Cyrano de Bergerac

5 anchors - Gironde, Garonne, Dordogne Rivers - 87 cabins



# MS Cyrano de Bergerac

The MS Cyrano de Bergerac cruises along the Gironde, Garonne and Dordogne Rivers.

## Interior design



## Cabins

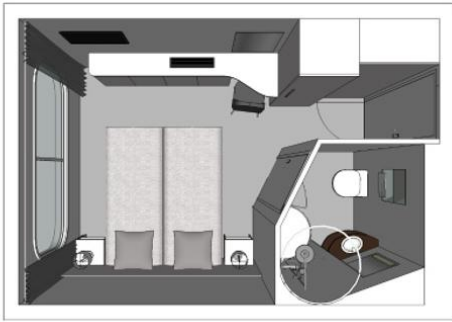

- Middle Deck 1 double bed 8 m<sup>2</sup>
- Middle Deck 2 beds - people with reduced mobility 13 m<sup>2</sup>
- Middle deck 2 adjustable twin beds 13 m<sup>2</sup>
- Main Deck 1 double bed 8 m<sup>2</sup>
- Main deck 2 adjustable twin beds 13 m<sup>2</sup>
- Upper Deck 1 double bed 8 m<sup>2</sup>
- Upper deck 2 adjustable twin beds 13 m<sup>2</sup>

## Cabins equipments

- TV
- Telephone (for internal calls only)
- Bathroom with shower and toilet
- Towels
- Safe
- Independent air-conditioning
- Electricity 220V
- Wi-Fi

Please note that there is no laundry service on board the ship.

## Decks and technical details

### MAIN DECK 25 cabins

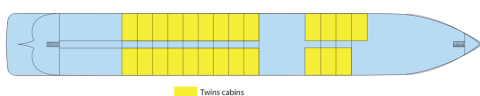

Twins cabins

### MIDDLE DECK 21 cabins

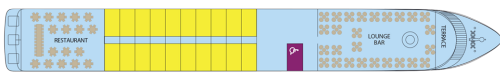

Twins cabins PRM cabins

### UPPER DECK 41 cabins

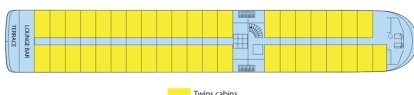

Twins cabins

**Year Built :** 2013

**Guest capacity :** 174

**Number of cabins :** 87

**Width :** 11.40

**Length :** 110

**Number of crew members :** 25

**Number of decks :** 3

**Elevators**

**Cabins outside**

**PRM cabins**

## SUN DECK

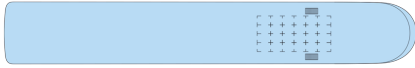

**MIDDLE DECK :** RESTAURANT - RECEPTION DESK - LOUNGE BAR WITH DANCEFLOOR

**UPPER DECK :** PIANORAMABAR - TERRACE

**SUN DECK :** FITNESS - SUN DECK